

XOR Bumper, Rear, 18-20 Jeep Wrangler JL

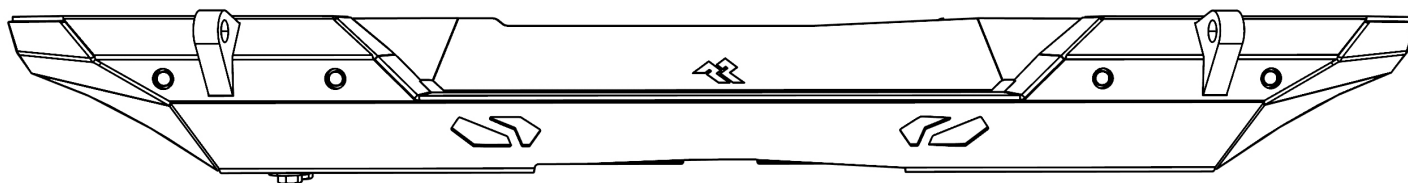
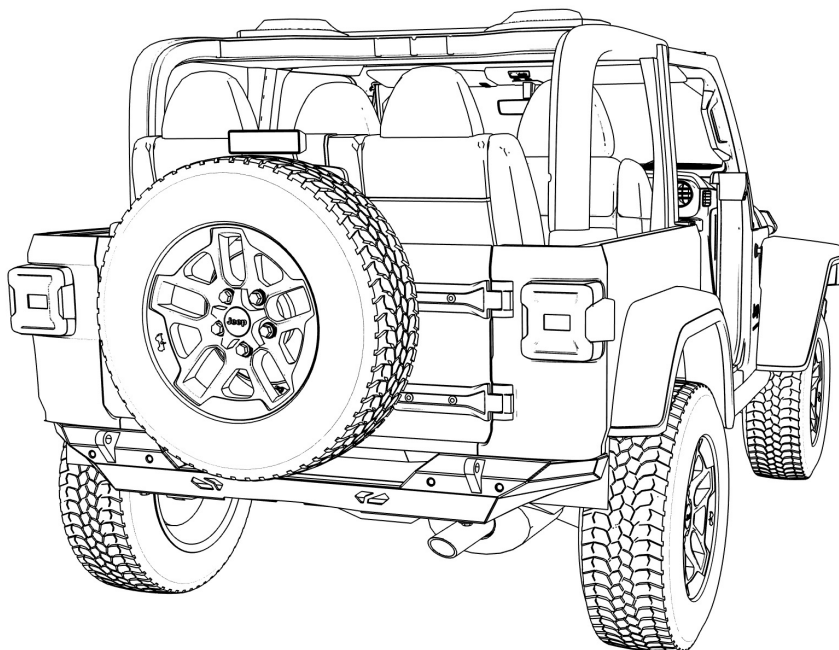

OMIX-ADA® TECHNICAL SUPPORT

PHONE: M-F 8am – 5pm EST 1-800-449-6649

FOR WARRANTY OR TECH CONCERNS, EMAIL: webmaster@omixsupport.com

ATTN: STATE OF CALIFORNIA CONSUMERS

⚠ WARNING: Cancer and Reproductive Harm – www.P65Warnings.ca.gov.

XOR Bumper, Rear; 18-20 Jeep Wrangler JL

COMPONENTS AND HARDWARE

Components

1. XOR Rear Bumper for 18-20 Jeep Wrangler JL (1)
2. Sensor Bracket (4)
3. Shim (2)
4. Nut Plate (1)

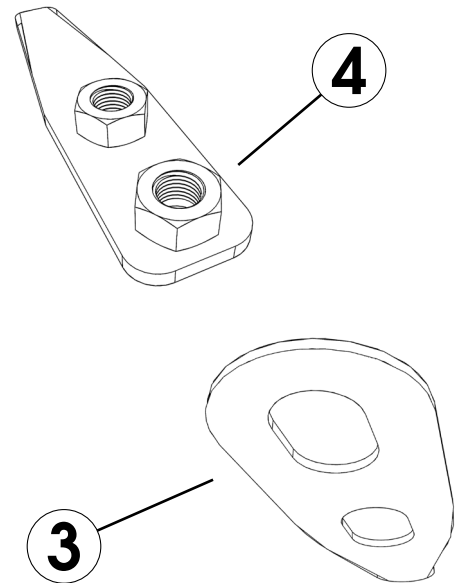
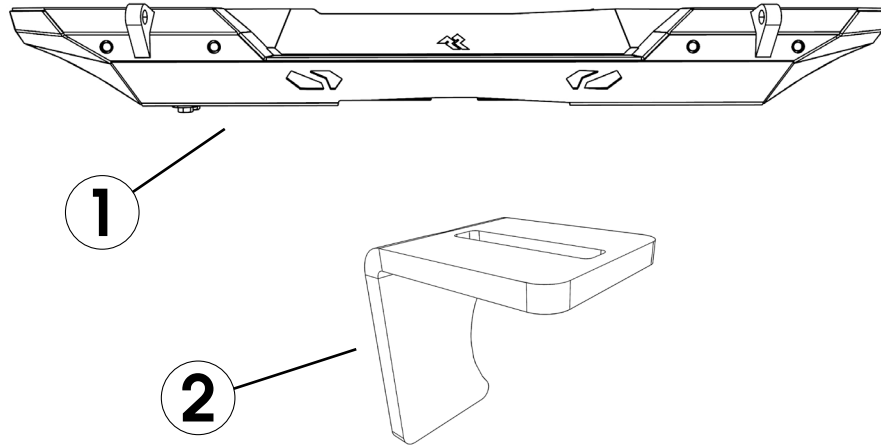

Hardware

1. M4 Hex Head Screw 155mm (4)
2. M4 Flat Washer 9mm (8)
3. M4 Nylock Nut (4)
4. M14 Hex Head 14 x 35 mm Screw (8)
5. M14 Flat Washer Oversized (8)

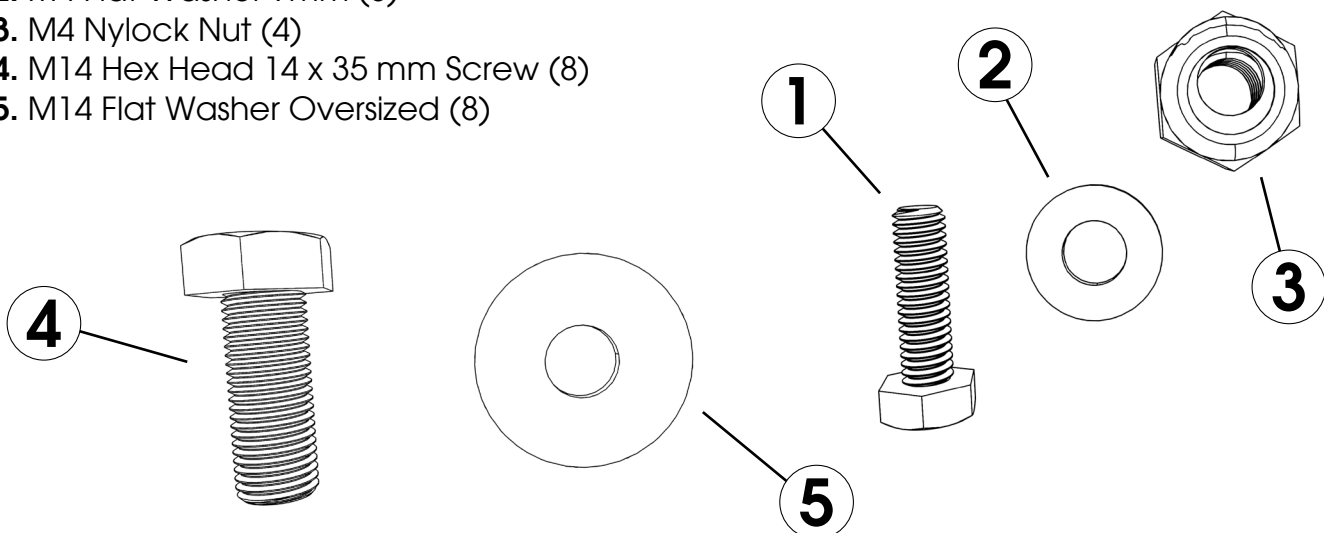

XOR Bumper, Rear; 18-20 Jeep Wrangler JL

INSTALLATION INSTRUCTIONS

1. Remove the OE bumper (see Jeep documentation for instructions, if needed).

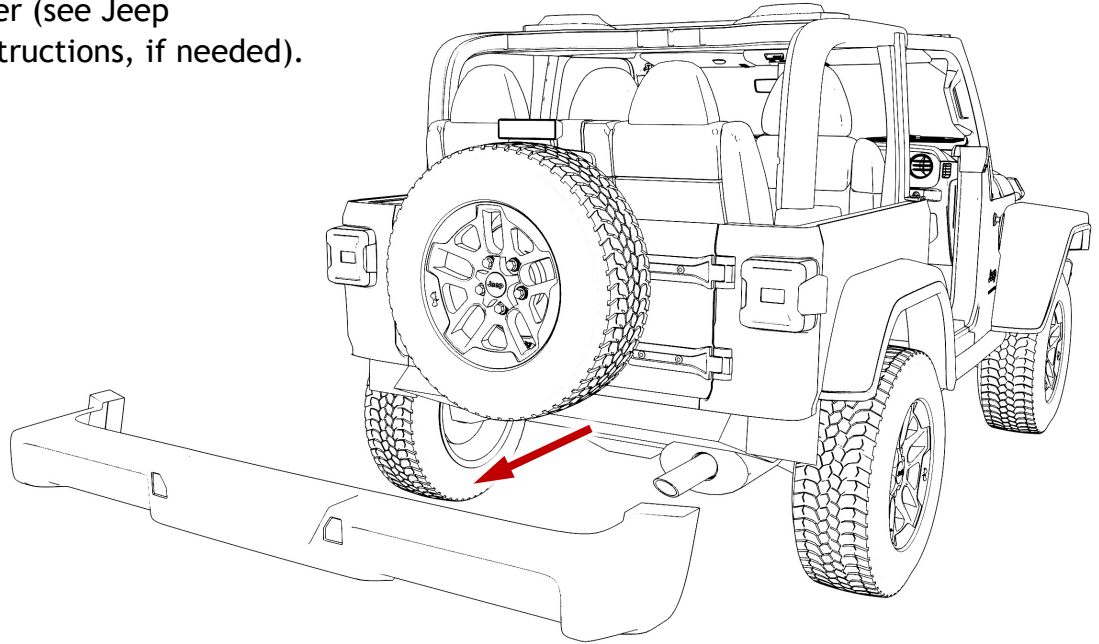

2. If the JL has no rear sensors, then leave the rubber plugs installed. Attach/tighten brackets to secure plugs. Skip to Step 9.

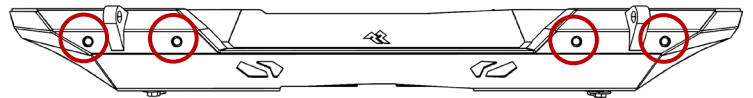

If the bumper has rear sensors, remove the four (4) rubber plugs from the brackets on the XOR Rear Bumper.

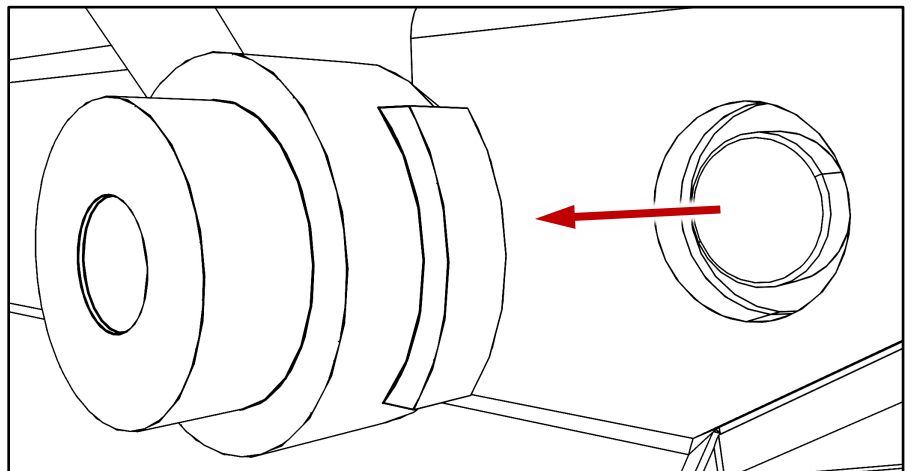

XOR Bumper, Rear; 18-20 Jeep Wrangler JL

- 3.** Remove the harness connectors from the sensors on the OE bumper. There's a gray clip on each one that can be pried backwards with a pick or screwdriver. Press the clip towards the wiring and pull the connector off. Repeat for all four of the sensors.

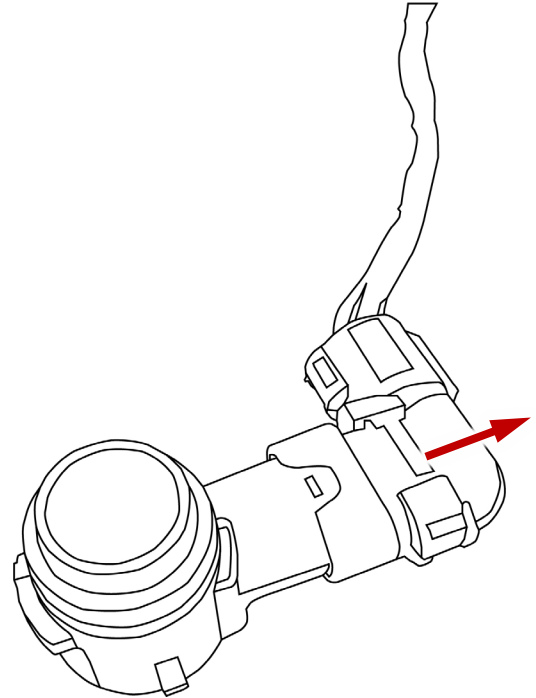
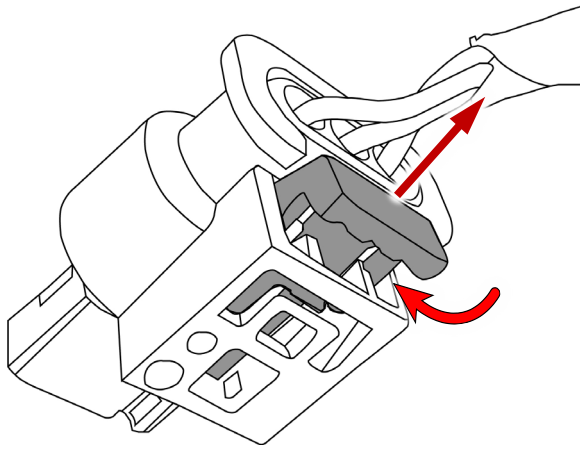

- 4.** Once all connectors are disconnected, use a flat-blade screwdriver to pop all the harness fasteners off the bumper. Remove the harness and set it aside. Label each sensor on the OE bumper (outer left, inner left, inner right, outer right) with a sharpie or by other means.

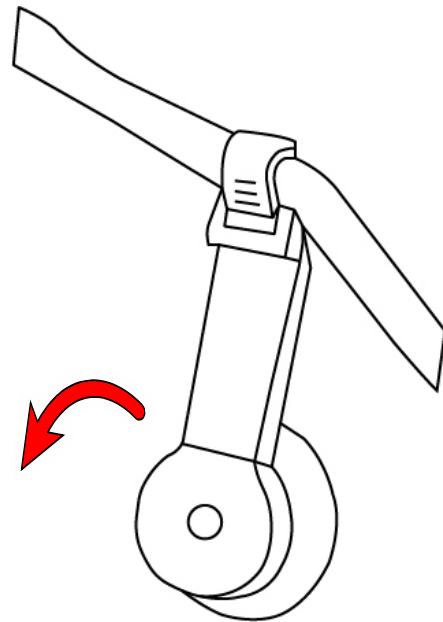

XOR Bumper, Rear; 18-20 Jeep Wrangler JL

5. Pre-install the four (4) rear back-up sensors to the XOR Rear Bumper according to their labeled positions. Remove the rings from the sensors. Each sensor will lock into the grooves of the XOR Rear Bumper. Note the orientation shown in the picture: all sensors should be pointing inwards toward the center of the bumper.

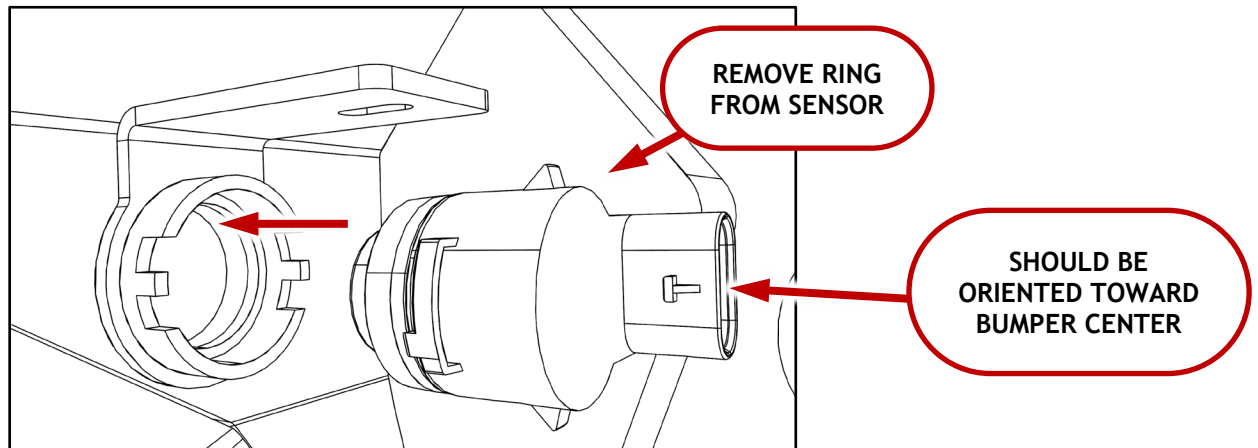
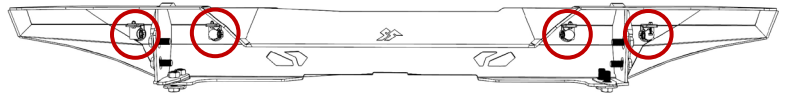

6. With the sensor locked into the grooves of the bumper, place the rear bracket against the back of the sensor. Next, use the M4 hardware to mount the bracket. For each bracket, this includes one (1) M4 hex head 155mm screw, one (1) M4 Nylock nut, and two (2) M4 9mm flat washers. Repeat for all sensors.

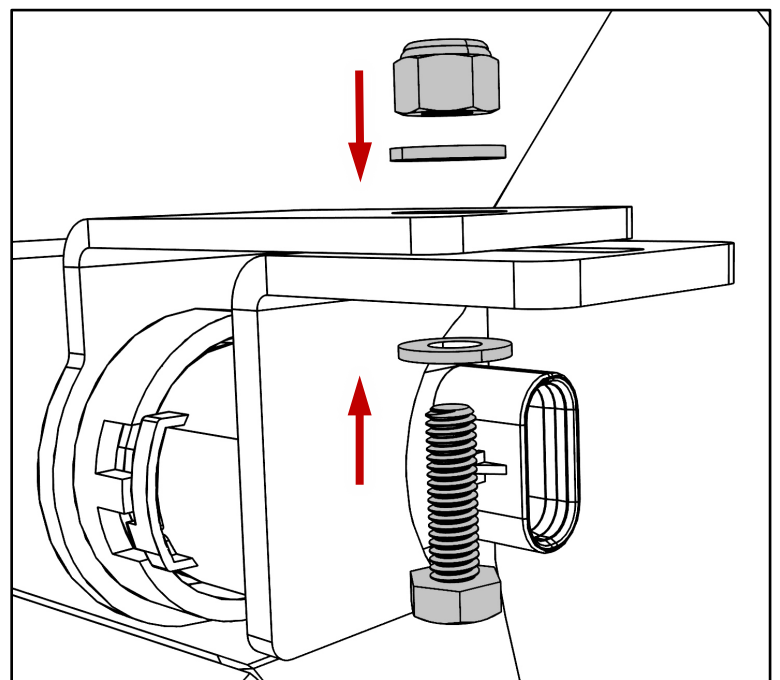

XOR Bumper, Rear; 18-20 Jeep Wrangler JL

7. Attach the wire harness connectors with the gray clips to the sensors. Keep in mind that the rear tag light plug with the red clip will also be adapted to the desired tag location.

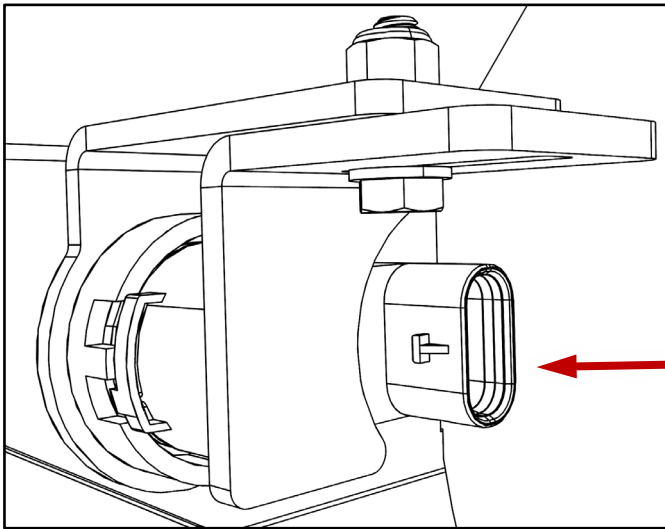

TO TAIL LIGHT
TAG LOCATION

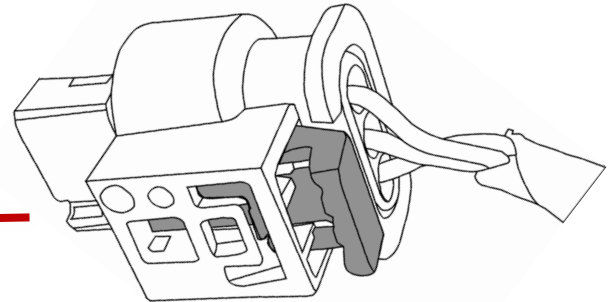
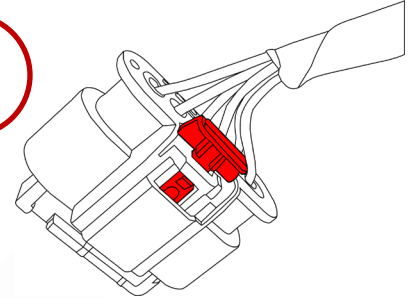

8. Route the wire harness so it won't be pitched during installation. Tighten the fasteners to the bumper. Zip-tie the harness as necessary to avoid having it be pinched between the bumper and the frame of the Jeep.

NOTICE

If the wire doesn't quite reach the connector, unwrap the wire and pull it out until enough length is given to make the connection.

NOTICE

Make sure to re-wrap the wires with electrical tape. Ensure any loose connectors are covered in electrical tape to avoid short-circuiting.

ROUTE WIRE
HARNESS AND ZIP-
TIE IF NECESSARY

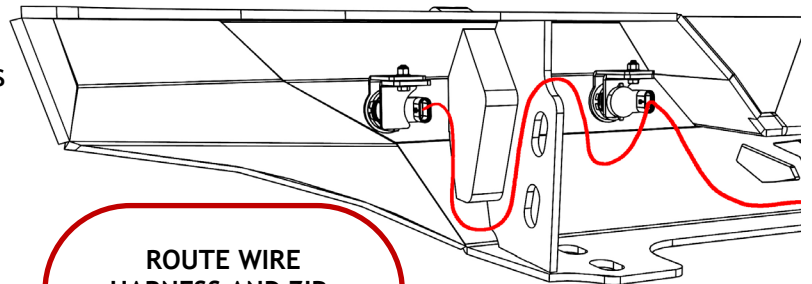

ATTACH FASTENERS
TO BUMPER AND
TIGHTEN

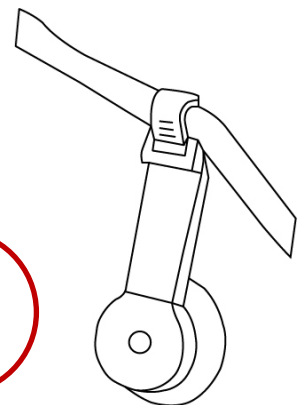

XOR Bumper, Rear; 18-20 Jeep Wrangler JL

- 9.** Place the nut plate inside the mounting extrusion on the passenger side of the Jeep frame. This can be adjusted after the bumper has been installed.

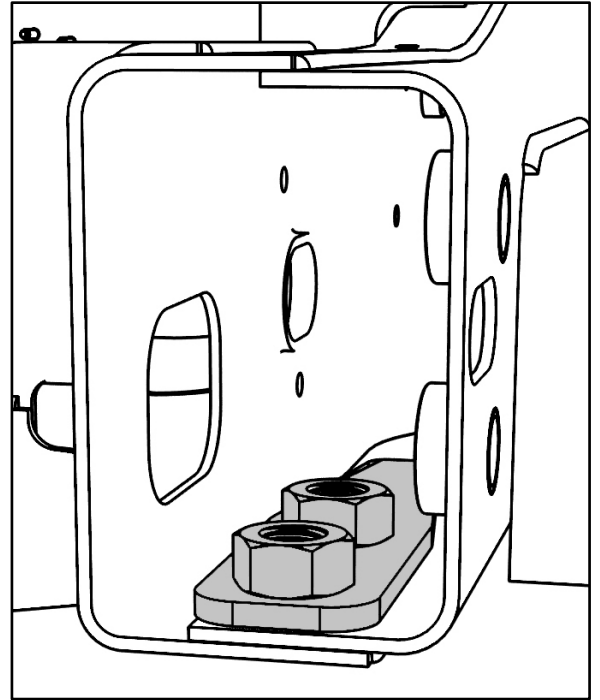
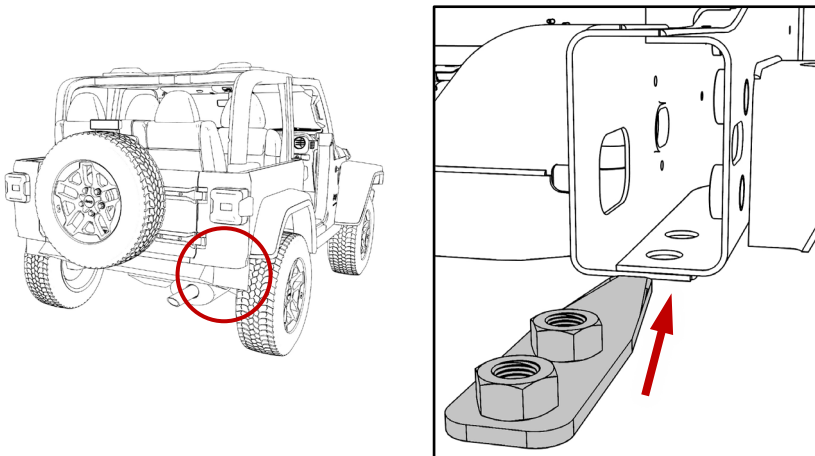

- 10.** With a person lifting on each end, lift the bumper and align the bumper mounting holes with the mounting holes on the back of the Jeep frame.

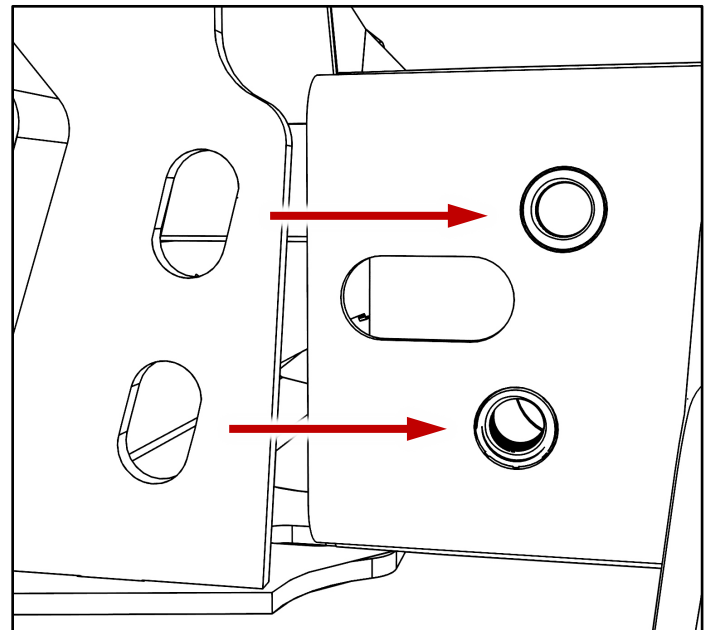
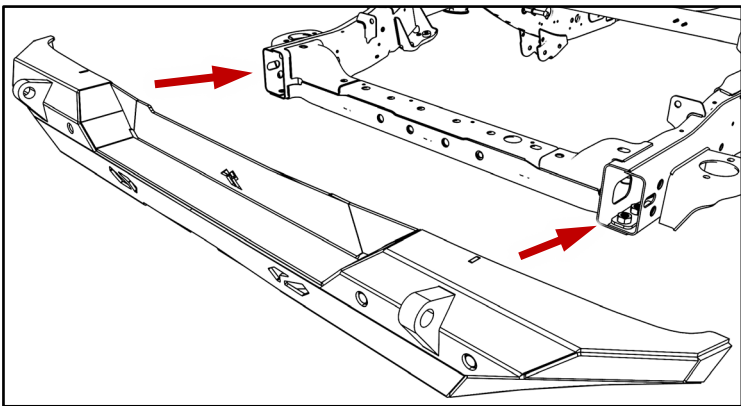

XOR Bumper, Rear; 18-20 Jeep Wrangler JL

- 11.** Install one (1) M14 flat washer and one (1) M14 hex head 14 x 35 mm screw to the topmost mounting hole on the driver side of the bumper. Tighten enough to hold the bumper to the frame, but do not make snug. Repeat for the passenger side.

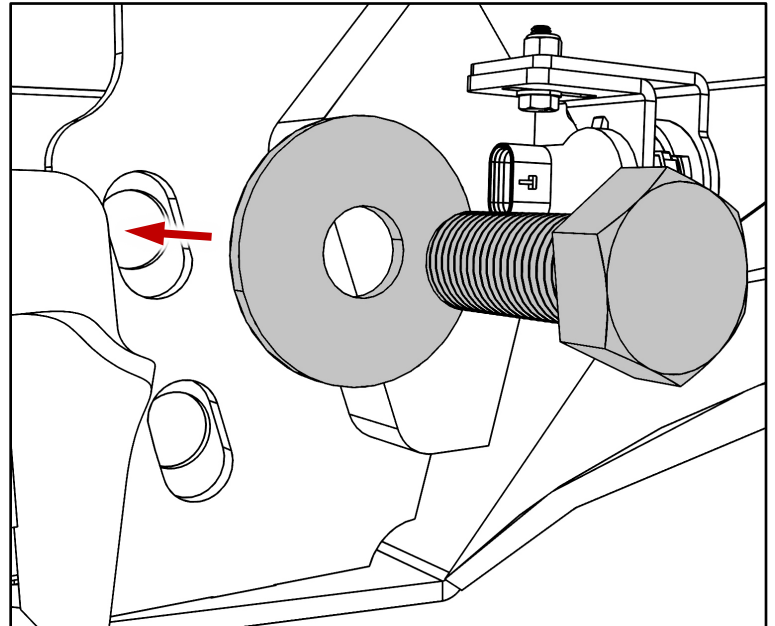

- 12.** Install the shim plate on the driver side of the bumper at the two bottom mounting points (between the frame and the bumper). Repeat for the passenger side.

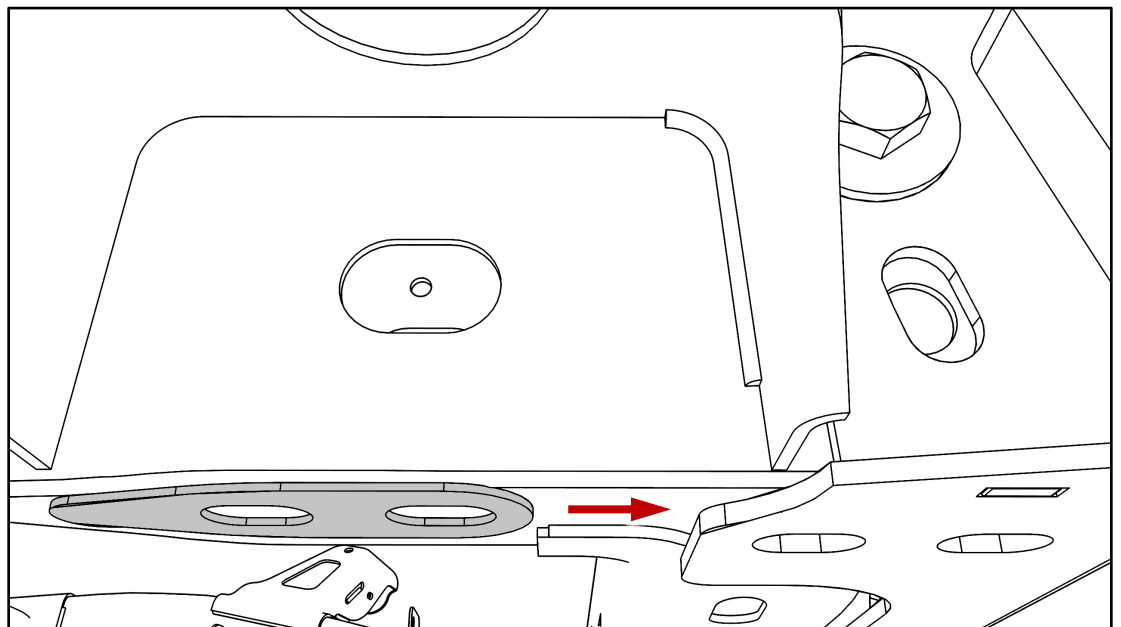

XOR Bumper, Rear; 18-20 Jeep Wrangler JL

- 13.** Install the rest of the M14 flat washers and M14 hex head 14 x 35 mm screws on the driver side at the three mounting points. Leave all hardware loose. Repeat for the passenger side.

The bumper has been engineered to allow space for adjustment. Check that the bumper is level, and that gaps between the body and the frame match on both sides. Once bumper is properly positioned, fully tighten all hardware with a 21mm ratchet wrench.

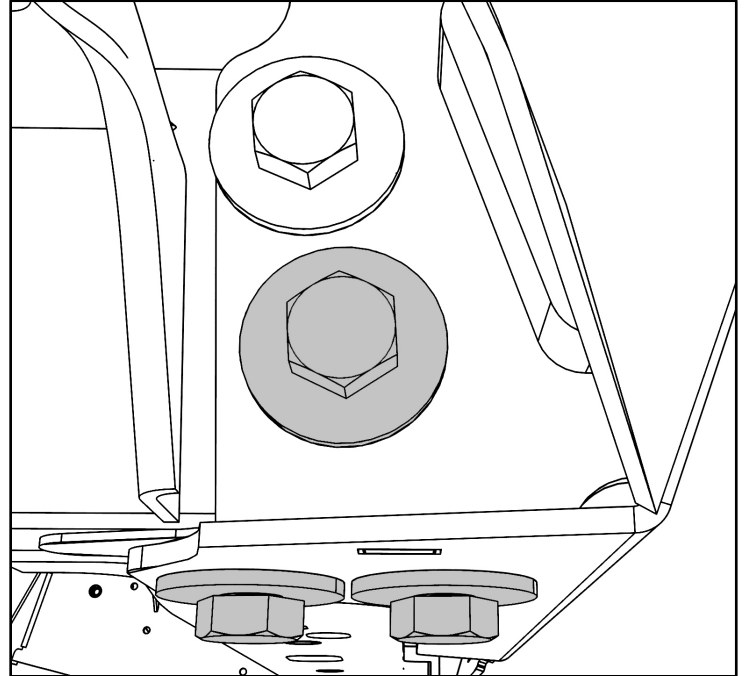

- 14.** The XOR Rear Bumper is now installed.

