

11700**HONDA ELEMENT LX & EX**

11/17/2020

GROSS LOAD CAPACITY WHEN USED AS A WEIGHT CARRYING HITCH: 2000 LBS. TRAILER WEIGHT & 200 LBS. TONGUE WEIGHT.

WARNING: ALL NON-TRAILER (WHEEL-LESS) LOADS APPLIED TO THIS PRODUCT MUST BE SUPPORTED BY 18050 STABILIZING STRAPS.

**WARNING: ** FAILURE TO PROPERLY SUPPORT NON-TRAILER LOADS WILL VOID PRODUCT WARRANTY ******WARNING: *** DO NOT EXCEED VEHICLE MANUFACTURER'S RECOMMENDED TOWING CAPACITY *****FOR MORE INFORMATION LOG ONTO WWW.CURTMFG.COM
HAVING INSTALLATION QUESTIONS? CALL TECHNICAL SUPPORT AT 877-287-8634

Parts List			
ITEM	QTY	PART NUMBER	DESCRIPTION
1	4	20-00103	NUT,SER-FLANGE,7/16-14 UNC,GRD8,YZ
2	2	10-10317	BOLT,CAR,7/16-14 UNC,2,GRD8,YZ
3	1	10-10444	U-BOLT,7/16-14 UNC,1-1/2,N/A,CZ
4	1	7_16 FISHWIRE	7/16" FISHWIRE
5	2	CM-SP108	2.00 X 0.88 X .125 SPACER

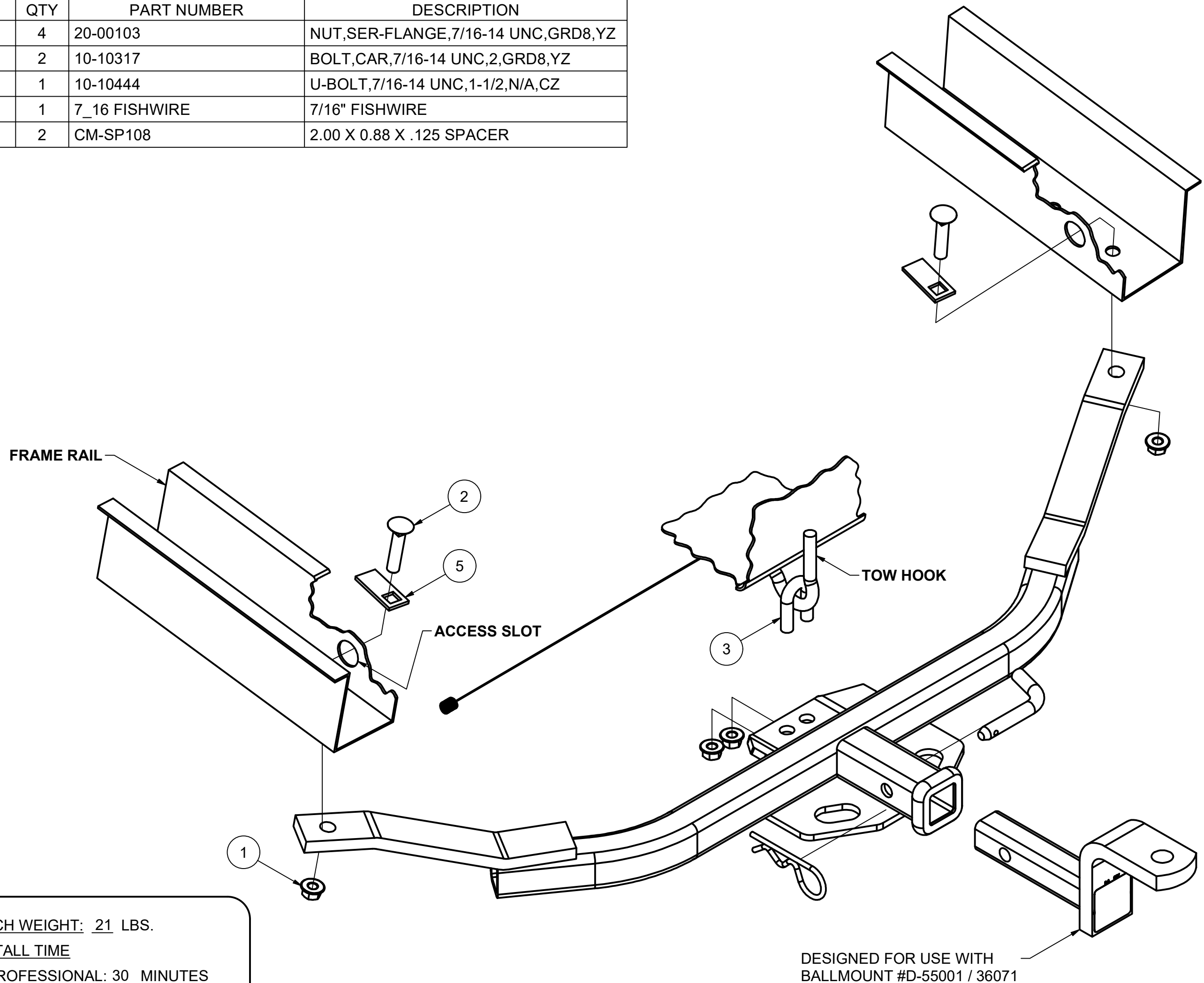

HITCH WEIGHT: 21 LBS.

INSTALL TIME

PROFESSIONAL: 30 MINUTES

NOVICE (DIY): 60 MINUTES

INSTALL NOTES:

- NO DRILLING REQUIRED
- MAY NEED TO ENLARGE ACCESS HOLE

DESIGNED FOR USE WITH
BALLMOUNT #D-55001 / 36071**INSTALLATION STEPS**

- 1) Fishwire 7/16" carriage bolts and spacers through access holes in each frame rail.
- 2) Raise hitch into position aligning holes in hitch to previously fishwired bolts.
- 3) Fasten hitch to frame rail using 7/16" flange nuts.
- 4) Hang U-bolt from tow hook as shown and fasten to mounting plate on forward side of hitch using 7/16" flange nuts.
- 5) Torque 7/16" carriage bolts to 59 lb.-ft. Torque 7/16" U-bolt to 25 lb.-ft.

PERIODICALLY CHECK THIS RECEIVER HITCH TO ENSURE THAT ALL FASTENERS ARE TIGHT AND THAT ALL STRUCTURAL COMPONENTS ARE SOUND.

CURT Manufacturing LLC., warrants this product to be free of defects in material and/or workmanship at the time of retail purchase by the original purchaser. If the product is found to be defective, CURT Manufacturing LLC., may repair or replace the product, at their option, when the product is returned, prepaid, with proof of purchase. Alteration to, misuse of, or improper installation of this product voids the warranty. CURT Manufacturing LLC.'s liability is limited to repair or replacement of products found to be defective, and specifically excludes liability for incidental or consequential loss or damage.

This product complies with safety specifications and requirements for connecting devices and towing systems of the state of New York, V.E.S.C.Regulation V-5 and SAE J684.