

# Pull-Pro / Winch bumper 53139 / 23366

## INSTALLATION INSTRUCTIONS Ford F-250 & F-350 Super Duty 2005-2007

### Parts List

| Item | Qty. | Code    | Description                 | Max. Torque |
|------|------|---------|-----------------------------|-------------|
| 1    | 1x   | 53139   | Grille Guard                | -           |
| 2    | 1x   | 5313943 | Main Bracket Set            | -           |
| 3    | 1x   | 5313941 | Auxiliary Bracket Set       | -           |
| 4    | 1x   | 5313940 | Upper Bracket Set           | -           |
| 5    | 1x   | 5312361 | License Plate Assembly      | -           |
| 6    | 12x  | -       | 1/2" x 1 1/2" Hex Head Bolt | 75 Lbs/ft   |
| 7    | 4x   | -       | 3/8" x 1 1/2" Hex Head Bolt | 31 Lbs/ft   |
| 8    | 2x   | -       | 3/8" x 1" Hex Head Bolt     | 31 Lbs/ft   |
| 9    | 2x   | -       | 1/4" x 1" Hex Head Bolt     | 9 Lbs/ft    |
| 10   | 6x   | -       | 1/2" Tab Bolt               | 75 Lbs/ft   |
| 11   | 2x   | -       | 1/4" Lock Nut               | -           |
| 12   | 18x  | -       | 1/2" Lock Nut               | -           |
| 13   | 6x   | -       | 3/8" Lock Nut               | -           |
| 14   | 18x  | -       | 1/2" Flat washer            | -           |
| 15   | 6x   | -       | 3/8" Flat washer            | -           |
| 16   | 2x   | -       | 1/4" Flat washer            | -           |

### Required Tools (Not included)

| Qty. | Description        |
|------|--------------------|
| 1x   | 3/4" Wrench        |
| 1x   | 3/4" Hex Socket    |
| 1x   | 9/16" Wrench       |
| 1x   | 9/16" Hex Socket   |
| 1x   | 7/16" Wrench       |
| 1x   | 7/16" Hex Socket   |
| 1x   | 7/32" Allen Wrench |
| 1x   | Ratchet            |

### Product Image



### Instructions

1. Before beginning the installation, please read all directions carefully and verify that all necessary hardware is accounted for. If any parts are missing, stop the installation and contact your distributor immediately.
2. To maintain and care this product, keep it clean and do not use abrasive cleaners or polish waxes. We recommend to use only automotive wax such as pure carnauba to avoid scratches and rust.
3. The approximate installation time is 60 min.
- 4 Remove the three 12 mm bolts and tow hook from each side of the vehicle **(See Figure A)**. To ease the installation □ we recommend removing the bumper.
5. In case you have a blocker bar installed, you need also to remove it and the three bolts under **(See Picture 1)**.  
\*In leaf spring front suspensions the blocker bar is also attached to the suspension bracket, remove the four bolts too **(See Picture 2)**.

**Figure A**

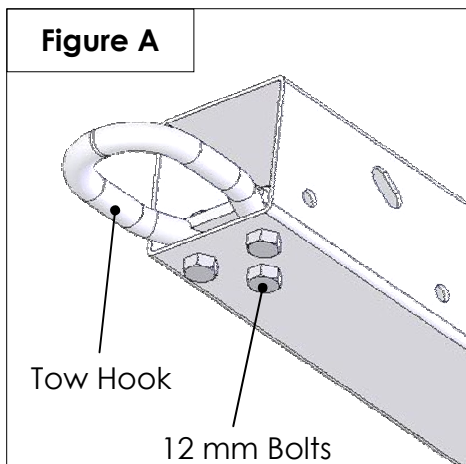

**Picture 1**

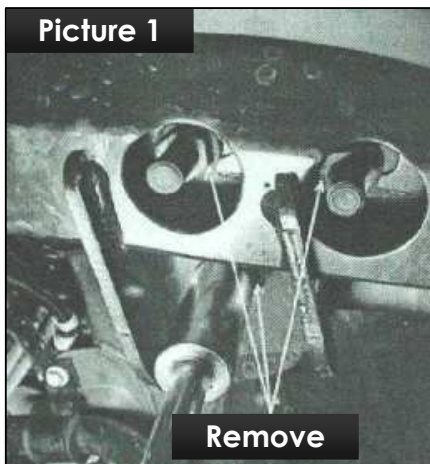

**Picture 2**

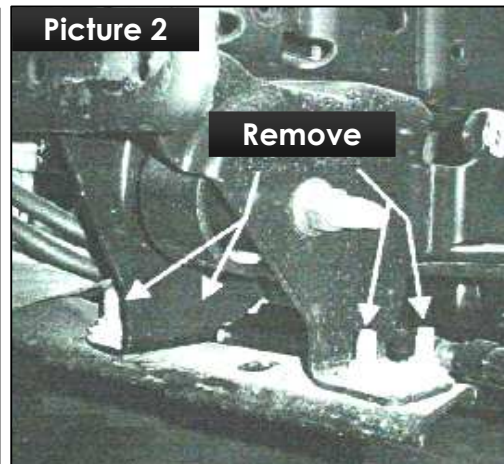

6. Fasten the auxiliary brackets (5313941) to the frame using the 1/2" tab bolts. Then attach the upper brackets (5313940) to the same auxiliary brackets (5313941) using 3/8" hex head bolts , 3/8" flat washers, and 3/8" lock nuts. **(See Figure B)**. On some models it may be required to drill the chassis due to the slot being in a different location.

7. Install the main brackets (5313943) to the frame rails aligning with the tow hook holes. Use 1/2 x 1 1/2" bolts, 1/2" flat washers, and 1/2" lock nuts per side. Tighten the hardware to the torque suggested on page 1.

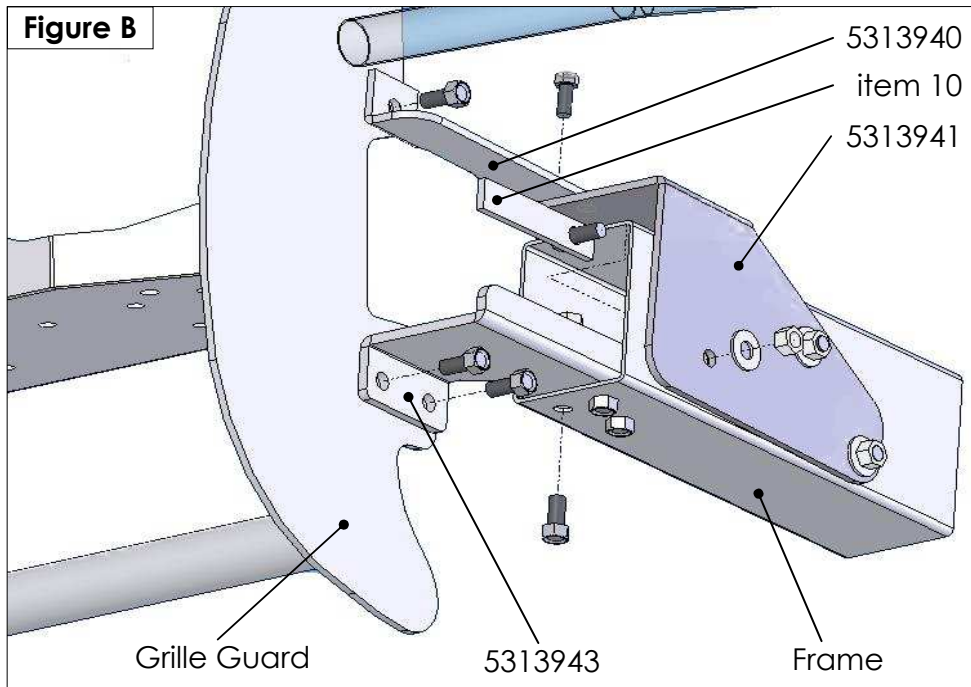

8. Reinstall the bumper if removed. The bumper should slip over the main brackets.
9. Reinstall the blocker bar if removed.
10. Install the Grille guard to the auxiliary brackets using the 3/8" x 1" bolts and lock nuts per side. Leave loose.
11. Install the Grille guard to the main brackets using 1/2" x 1 1/2" bolts and 1/2" lock nuts per side. Leave loose.
12. Install the tow hooks to the underside of the winch tray using the 12mm tow hook bolts (**See Figure C**).
13. Install the License Plate bracket under the winch tray using two 3/8" hex head bolts.
- Warning: Check individual state laws before to install license plate properly.**
14. Make any final alignments and/or adjustments and make sure that the vehicle's hood does not interfere with any part of the grille guard. Once all adjustments are made, tighten all bolts securely.
15. Periodically check and retighten bolts as necessary over the term of use.

