

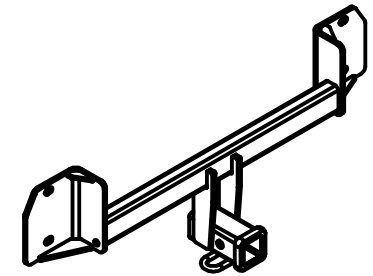

Class III Receiver Hitch

Part No. 69597C



Fits: BMW X3 AND X4



GROSS LOAD CAPACITY WHEN USED AS A WEIGHT CARRYING HITCH: 3,500 LBS. TRAILER WEIGHT & 350 LBS. TONGUE WEIGHT.
 GROSS LOAD CAPACITY WHEN USED AS A WEIGHT DISTRIBUTION HITCH: 4,000 LBS. TRAILER WEIGHT & 400 LBS. TONGUE WEIGHT

WARNING: * DO NOT EXCEED VEHICLE MANUFACTURER'S RECOMMENDED TOWING CAPACITY. *****



Parts List			
ITEM	QTY	PART NUMBER	DESCRIPTION
1	16	M6 RIVET	NYLON RIVET (AUVECO #20754)

TOOLS REQUIRED
PLASTIC RIVET GUN
8, 10, 18mm SOCKETS
RATCHET
FLAT HEAD SCREWDRIVER
TORQUE WRENCH
TAPE MEASURE
ROTARY CUTTING TOOL
SMALL PUNCH
SAFETY GLASSES

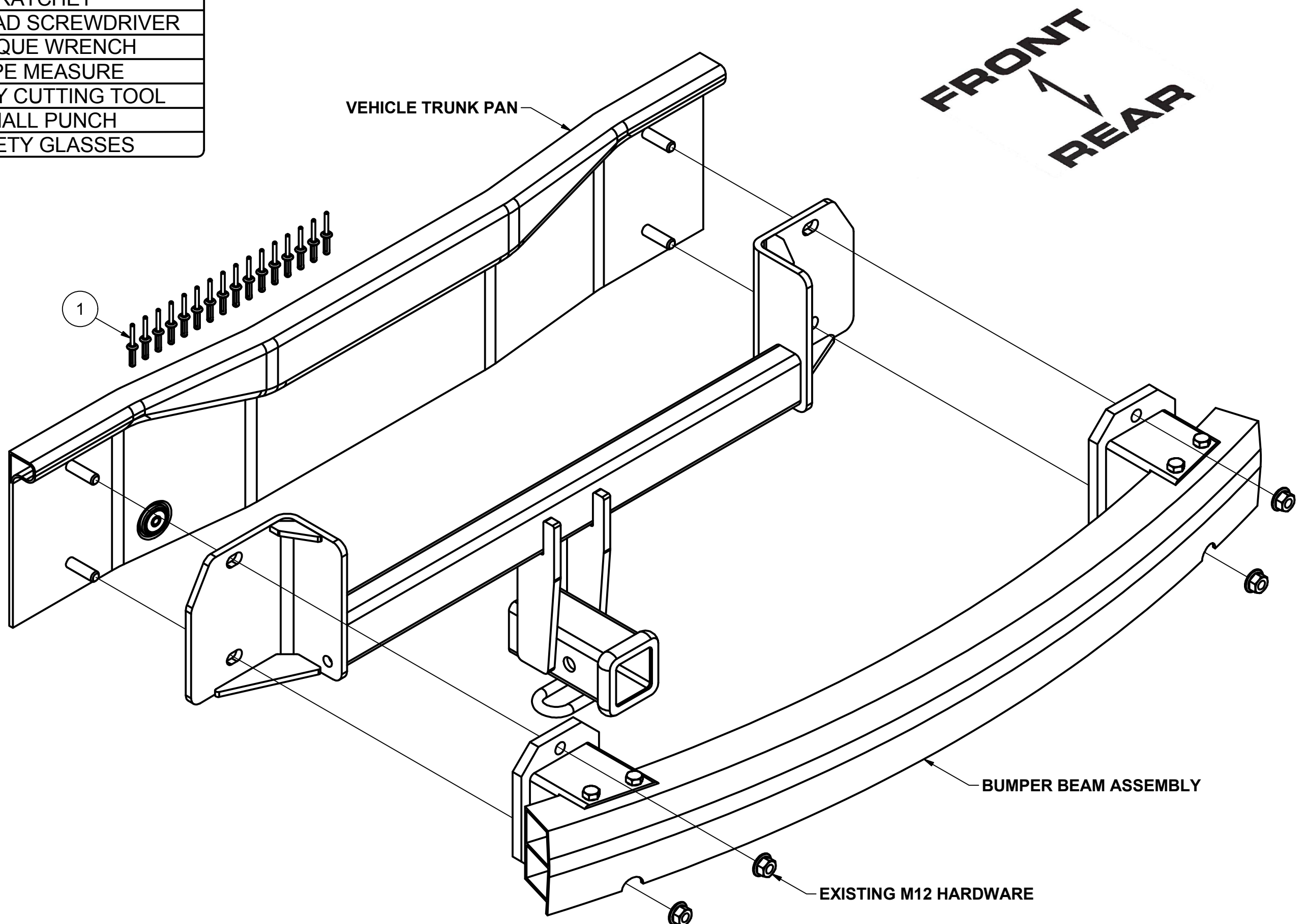

UNDERBODY PANEL TRIM DIAGRAM

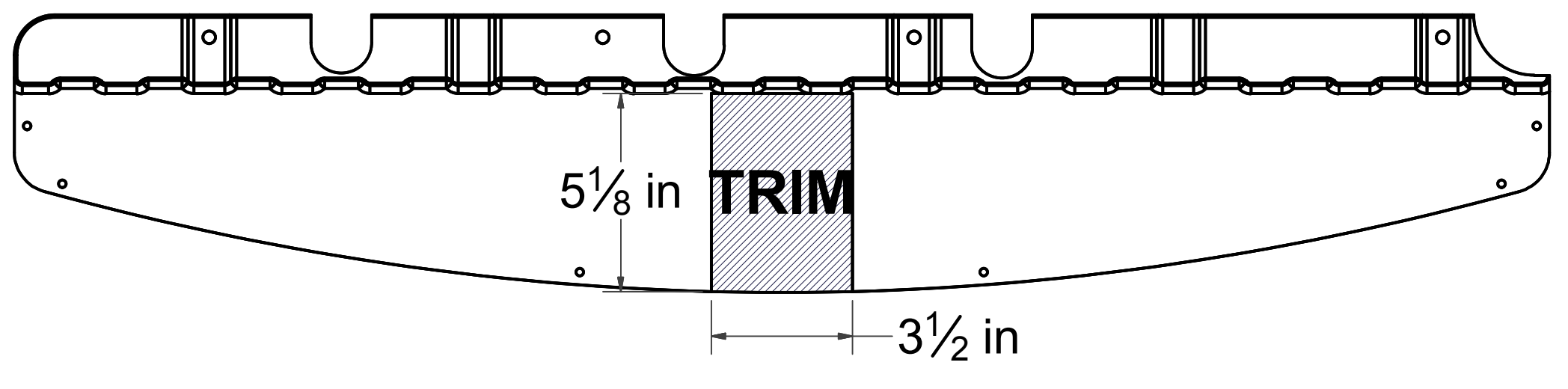

HITCH WEIGHT: 27 LBS.

INSTALL TIME

PROFESSIONAL: 90 MINUTES

NOVICE (DIY): 180 MINUTES

INSTALL NOTES:

- REMOVE BUMPER
- TRIM UNDERBODY PANEL
- NO DRILLING REQUIRED

PERIODICALLY CHECK THIS RECEIVER HITCH TO ENSURE THAT ALL FASTENERS ARE TIGHT AND THAT ALL STRUCTURAL COMPONENTS ARE SOUND.

Keystone Automotive Operations Inc., warrants this product to be free of defects in material and/or workmanship at the time of retail purchase by the original purchaser. If the product is found to be defective, Keystone Automotive Operations Inc., may repair or replace the product, at their option, when the product is returned, prepaid, with proof of purchase. Alteration to, misuse of, or improper installation of this product voids the warranty. Keystone Automotive Operations Inc.'s liability is limited to repair or replacement of products found to be defective, and specifically excludes liability for incidental or consequential loss or damage. This product complies with safety specifications and requirements for connecting devices and towing systems of the state of New York, V.E.S.C. Regulation V-5 and SAE J684. For Technical & Warranty Support: 1-877-544-4449 Fax- 1-855-242-8922 www.huskytow.com

11202017



Class III Receiver Hitch Part No. 69597C

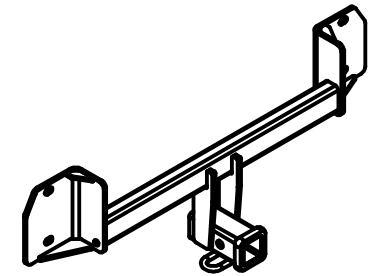

Fits: **BMW X3 AND X4**



GROSS LOAD CAPACITY WHEN USED AS A WEIGHT CARRYING HITCH: 3,500 LBS. TRAILER WEIGHT & 350 LBS. TONGUE WEIGHT.
GROSS LOAD CAPACITY WHEN USED AS A WEIGHT DISTRIBUTION HITCH: 4,000 LBS. TRAILER WEIGHT & 400 LBS. TONGUE WEIGHT

WARNING: * DO NOT EXCEED VEHICLE MANUFACTURER'S RECOMMENDED TOWING CAPACITY. *****

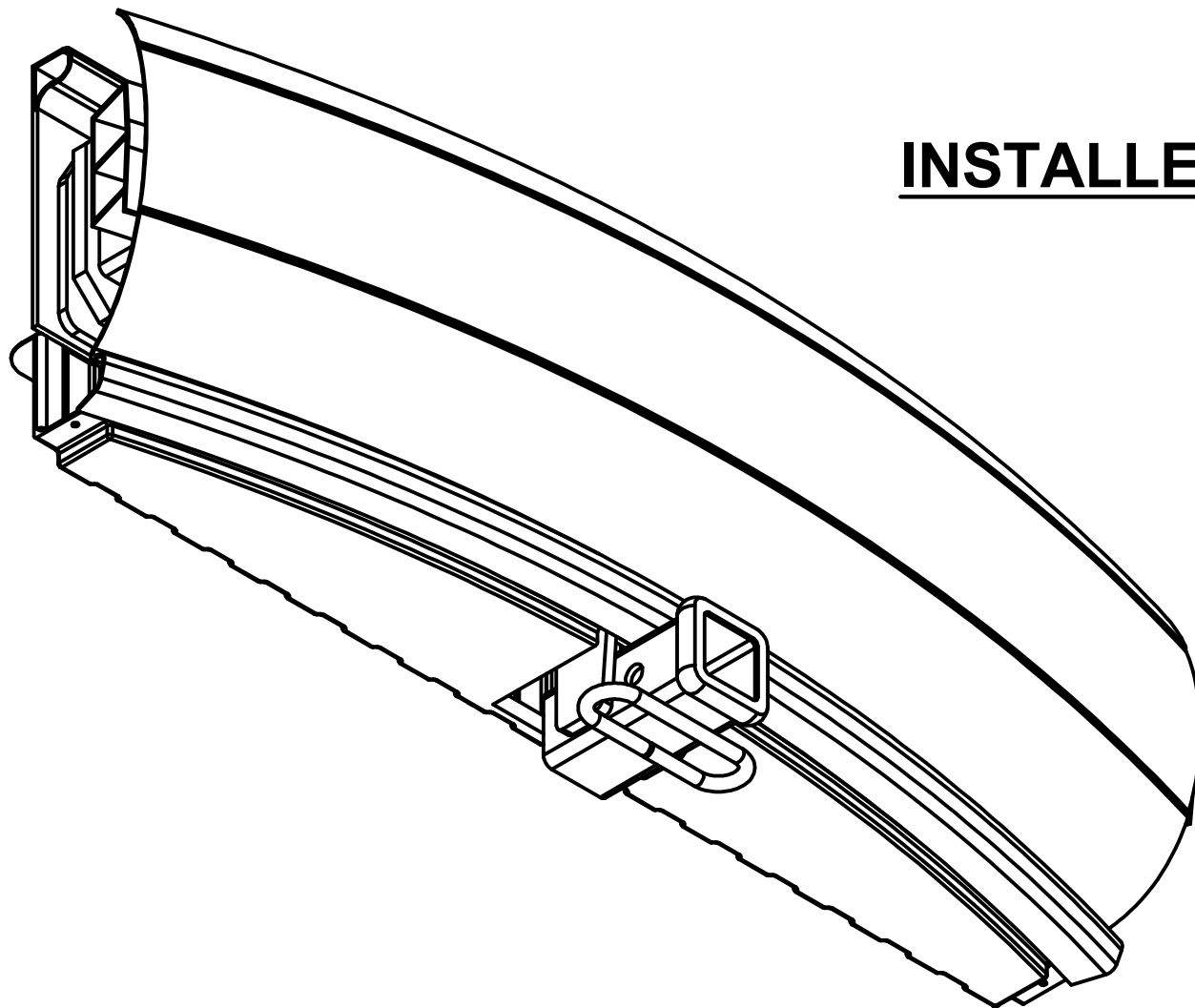

INSTALLED POSITION

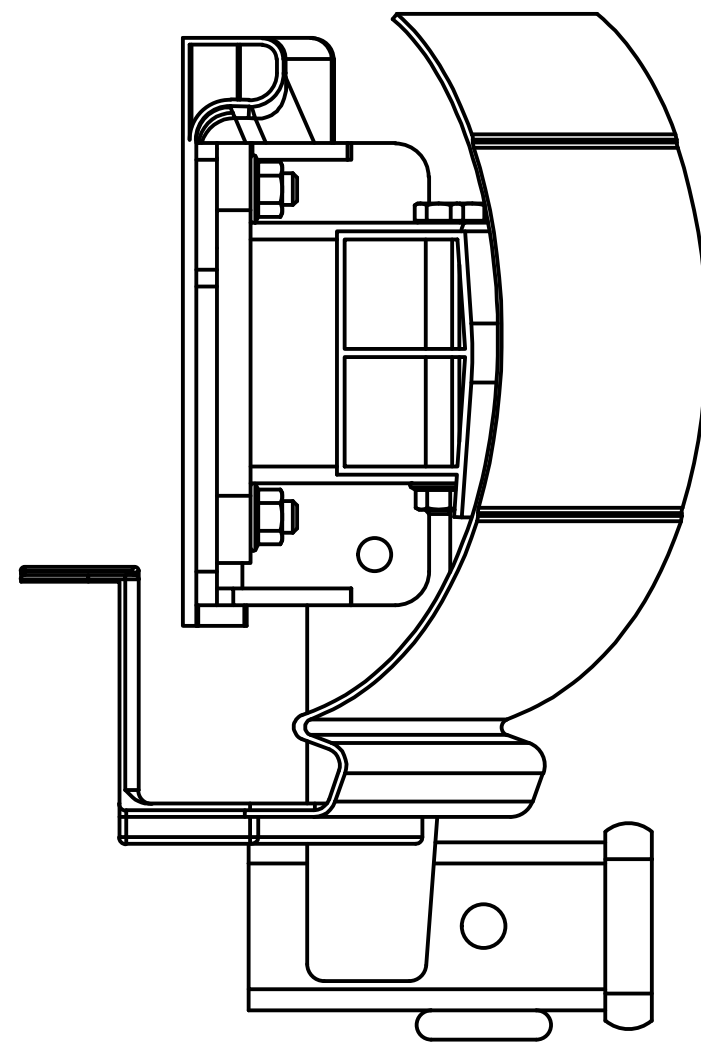

INSTALLATION STEPS

1. Remove underbody panel by removing (11) fasteners. Some models may require removal of (9) fasteners.
2. Remove (2) fasteners from bottom of bumper cover and (1) fastener from inside wheel well on each side. These are located behind rear tire. Some models may require removal of (1) plastic rivet from bottom of bumper on each side.
3. Remove (7) rivets from wheel well trim from above each rear tire. To remove rivets push small center rod through rivet with a small punch or an equivalent tool. Pry rivets from trim and pop trim off. **Note:** Replacement rivets are included.
4. Remove (2) fasteners from each side of bumper cover which are now accessible due to wheel well trim removal.
5. Pop off plastic covers located to the inside of each tail light.
6. Remove (2) nuts from each tail light. Unplug and remove each tail light.
7. Remove (1) fastener from under each tail light.
8. Pop (2) reflectors off of bumper cover and remove (1) fastener from under each.
9. Carefully remove bumper cover. Pop sides off first and then pull straight back.
10. Remove (2) inner plastic bodies by removing (4) nuts from each.
11. Remove bumper beam assembly by removing (4) nuts from threaded studs. These nuts will be used to install hitch.
12. Raise hitch and bumper beam into position onto threaded studs and secure to vehicle using the M12 nuts removed in STEP 11.
13. Torque all M12 hardware to 86 ft-lbs.
14. Hold inner plastic bodies in position and mark where the hitch side plates interfere. Trim an approximate 3/8" wide by 7/8" deep slot into each inner plastic body to allow for side plate clearance.
15. Reinstall bumper cover and tail lights by reassembling components removed in STEPS 2-10 in reverse order. **Note:** A plastic rivet gun is required to fasten supplied rivets when reinstalling wheel well trim.
16. Raise underbody panel into position and mark the center using the hitch as a guide. Trim underbody panel. See UNDERBODY PANEL TRIM DIAGRAM on PAGE 1. Reinstall underbody panel and discard extra fastener.

PERIODICALLY CHECK THIS RECEIVER HITCH TO ENSURE THAT ALL FASTENERS ARE TIGHT AND THAT ALL STRUCTURAL COMPONENTS ARE SOUND.