



KIT, SERVICE, 16K HUSKY

10 CLEVIS/COTTER PIN

Part # 31797



Dealer / Installer: Provide a copy of these Instructions to the end user of this product. These Instructions provide important operating and safety information for proper usage of this product. Demonstrate the proper use of the product with the end user. Have the end user demonstrate that they understand the proper use of the product.

End User: Read and follow all instructions included in this manual. Ask your Dealer / Installer for assistance if you do not understand the proper use of the product. Never remove any decals from the product.

KIT CONTENTS

Parts listing	
Item no.	Description
1	Cotter Pins
2	Long Clevis Pin(1)
3	Short Clevis Pin(1)

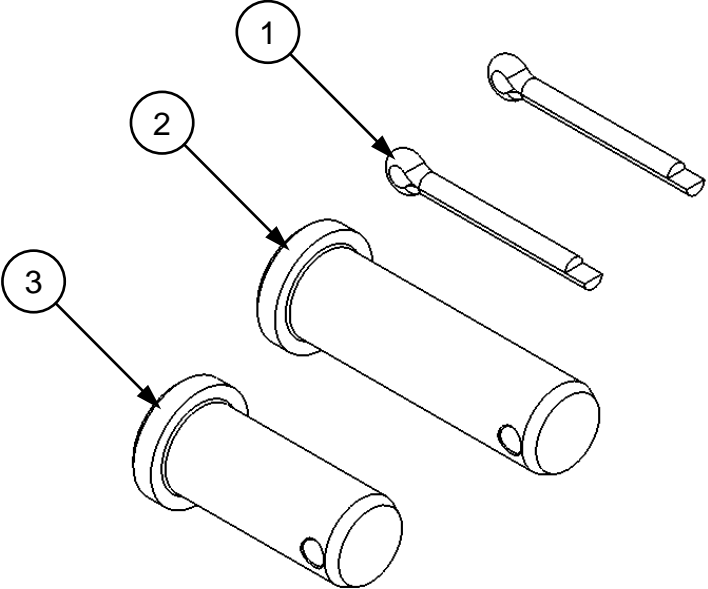

Tools required
Needle nose pliers

1. Remove items labeled 1-3 and discard.
2. Install new components noting that the longer clevis pin goes in position noted 2 and the shorter clevis pin goes in position noted 3.
3. Install cotter pins and bend legs over being careful not to bend too far to damage them.
4. No adjustments should be needed but when finished, ensure the system operates properly.

