

The material that your product is made from can be recycled. Please also consider recycling the packaging that your product came in.

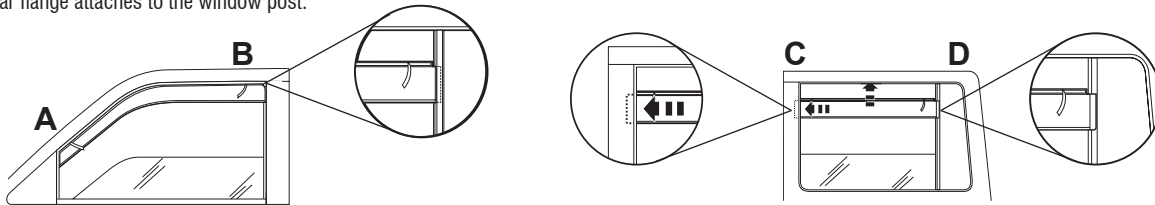

- 1 Clean the window channel with an alcohol pad.
- 2 Remove tape liner from front flange. Peel back 2" (5 cm) of tape liner from each end of top flange.
- 3 Insert visor into window channel, rear flange first. Rear flange inserts between the rubber and frame. The front & top flange slides into the window channel.
- 4 Remove tape liner by pulling on free ends. Raise window slowly and leave up for 24 hours to secure visor to window channel.  
**NOTE:** It may be necessary to pull the window channel out at the rear to seat the rear flange.
- 5 Remove tape liner by pulling on free ends. Raise window slowly and leave up for 24 hours to secure visor to window channel.
- 6 Install the rear visors using the same preparation and installation methods as the front visor. Note that front flange fits between the rubber and frame, and the rear flange attaches to the window post.



**IMPORTANT:** Clean with a **SOFT** cloth and soap and water **ONLY!** Using abrasive cleaners, chemicals, or solvents will **VOID** the warranty on this product.  
Stampede Automotive Products • Visit us at [stampedeproducts.com](http://stampedeproducts.com) • 800-858-5634

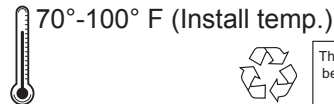
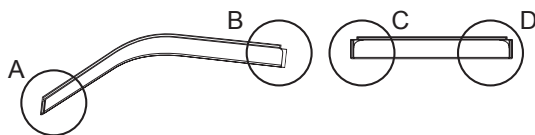

The material that your product is made from can be recycled. Please also consider recycling the packaging that your product came in.



- 1 Clean the window channel with an alcohol pad.
- 2 Remove tape liner from front flange. Peel back 2" (5 cm) of tape liner from each end of top flange.
- 3 Insert visor into window channel, rear flange first. Rear flange inserts between the rubber and frame. The front & top flange slides into the window channel.
- 4 Remove tape liner by pulling on free ends. Raise window slowly and leave up for 24 hours to secure visor to window channel.  
**NOTE:** It may be necessary to pull the window channel out at the rear to seat the rear flange.
- 5 Remove tape liner by pulling on free ends. Raise window slowly and leave up for 24 hours to secure visor to window channel.
- 6 Install the rear visors using the same preparation and installation methods as the front visor. Note that front flange fits between the rubber and frame, and the rear flange attaches to the window post.

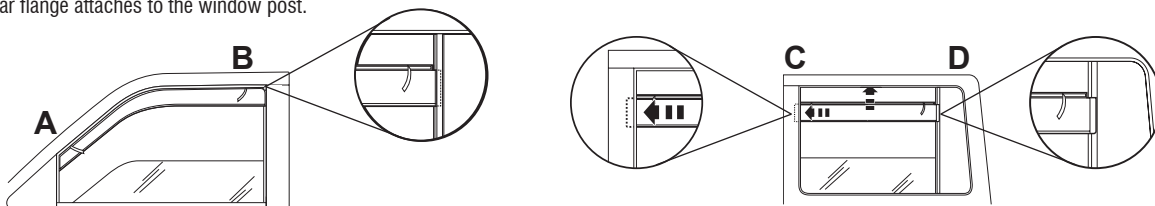

**IMPORTANT:** Clean with a **SOFT** cloth and soap and water **ONLY!** Using abrasive cleaners, chemicals, or solvents will **VOID** the warranty on this product.  
Stampede Automotive Products • Visit us at [stampedeproducts.com](http://stampedeproducts.com) • 800-858-5634