

1. Clean hood shield mounting location.
2. Peel back tape liner.
3. Center hood shield and attach with exposed tape. Remove tape liner. **NOTE:** The hood shield should be offset approximately 3/4" (1.9 cm) from the front edge of hood.
4. Apply pressure to tape flange.
5. **Optional Screw Attachment:** See detail below. **NOTE:** Use caution not to push too hard on self tapping screw and puncture outer hood surface!
6. Lower hood, adjust hood bumper stops if necessary. Apply bump-ons to hood surface.

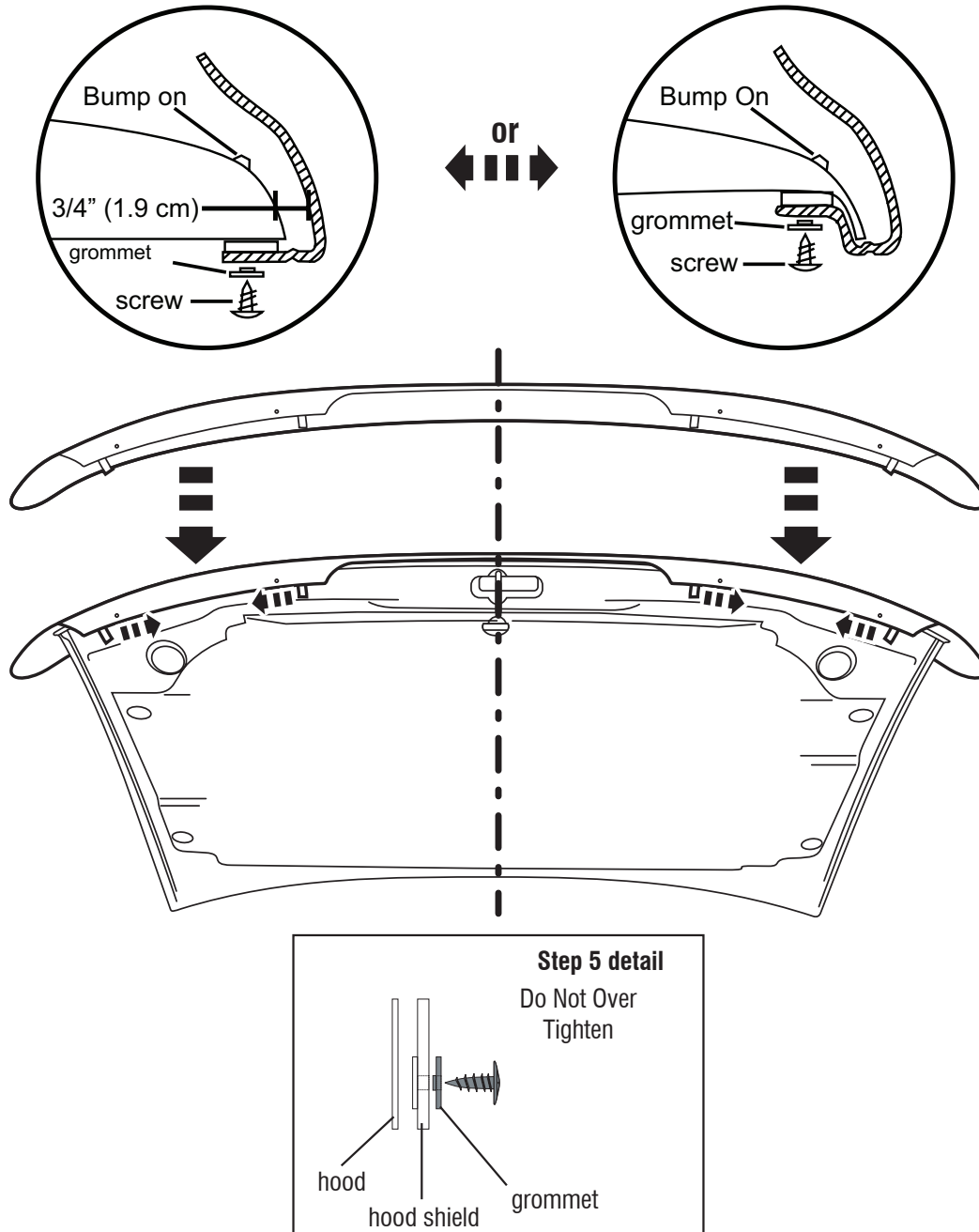

IMPORTANT: Before driving, ensure the hood shield is properly secured to vehicle. Clean with a **SOFT** cloth and soap and water **ONLY!** Using abrasive cleaners, chemicals, or solvents will **VOID** the warranty on this product.