



## STEP 1 – PRIOR TO INSTALLATION

- A) Bushwacker only approves installing the cowl guard according to these written instructions with the hardware provided. WARNING: Failure to install according to these instructions will invalidate the warranty. This includes, but is not limited to using alternative installation methods, hardware, or materials. DO NOT USE: Loctite, SuperGlue, or similar products on the hardware or the flares.**
- B) Fit:** Verify the fit of the triple gauge pod. (Some filing, sanding, or cutting may be necessary to ensure proper fit).
- C) Painting:** (Optional) if paint is desired it must be done prior to installing triple gauge pod on dash. Clean outer surface with a good grade degreaser. DO NOT USE LACQUER THINNER OR ENAMEL REDUCER AS A DEGREASER. Wipe outer surface thoroughly with a tack rag prior to paint. Application of plastic adhesion promoter for TPO plastic as per your paint system manufacturer's recommendations is required. Paint triple gauge pod using a high quality enamel, or polyurethane automotive paint. If painting edge trim (not recommended), use a flex additive.

## Jeep JK Cowl Guard

Unit Part #14015

Rev-0 4/12/2016

For complete fitment info visit : [www.bushwacker.com](http://www.bushwacker.com)

### TOOLS FOR EASY INSTALLATION:

- Cleaning cloth

### LIMITED LIFETIME WARRANTY AGAINST ANY MANUFACTURING DEFECTS

- To claim a warranty, you must provide Proof of Purchase.

## Included in Hardware Kit:

1.



AD1-0008,  
ALCOHOL PREP  
PAD,  
2 pcs

# Installation Procedures



Clean all dirt and debris from installation area.



Using the supplied alcohol wipe, clean area where part will be placed. *NOTE: Temperature should be between 60°F and 110°F for proper tape adhesion.*

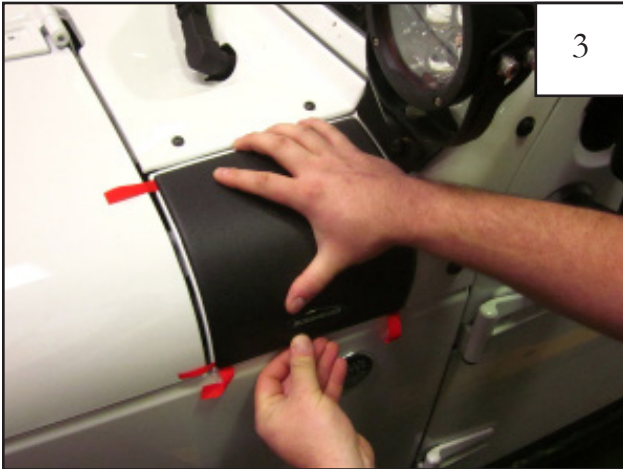

Align part on the vehicle and make sure tape tabs are folded out so they are accessible.

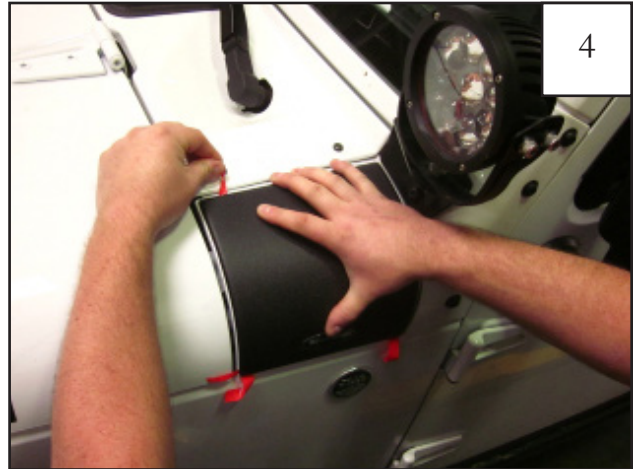

Begin by pulling the top tape liner first.

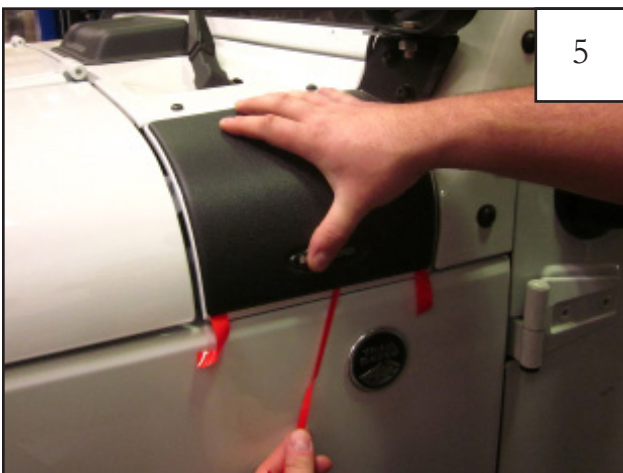

Pull liner of lower 1/4" tape strip. Press down on entire length of part applying 30 PSI to the taped areas.

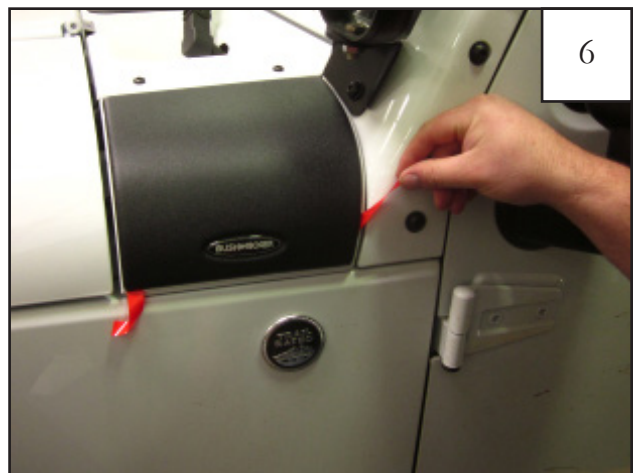

Pull liner located at the rear toward the door. Press down on entire length of part applying 30 PSI to the taped areas.



Pull liner located at the front toward the hood. Press down on entire length of part applying 30 PSI to the taped areas.



Apply 30 PSI for 30 seconds on each section of the part to ensure proper adhesion. *NOTE: The tape reaches maximum adhesive bond after 24 hours of contact.*



Installation complete.